

## LS 9 Volt primary lithium thionyl chloride (Li-SOCl<sub>2</sub>) High Energy Density battery pack



A prismatic battery pack for a wide range of applications requesting low base currents combined with superimposed pulses.

Two versions are available, depending on the envisioned temperature range. The LSC 9V version yields superior voltage readings and operating life in cool environments (i.e. indoor applications with possible T excursions up to +55°C).

The LS 9V version yields good voltage readings in a wider T range (-60 to +85°C).

### Pack construction

	3 LS 14250 in series	3 LS 14250C in series
Pack designation	LS 9V	LSC 9V
Part number	04699G	04700H

### Electrical characteristics

(typical values for packs stored for one year or less)

Nominal capacity	1.0 Ah (1.5 mA)	1.2 Ah (1.5 mA)
------------------	--------------------	--------------------

(at +20°C; 6 V cut off and for a given discharge current.

The capacity restored by the cell varies according to current drain, temperature and cut off)

Open circuit voltage (at +20°C)	11 V	11 V
Nominal voltage (at +20°C and 1.5 mA)	9.0 V	9.0 V

Pulse capability : Typically up to 15 mA. (Varies according to pulse characteristics, temperature, cell history and the application's acceptable minimum voltage. Consult Saft)

Continuous current permitting 50% of the nominal capacity. (Higher currents possible, consult Saft)	40 mA	15 mA
---	-------	-------

Storage (recommended) (for more severe conditions, consult Saft)	+30°C max	+30°C max
--	-----------	-----------

Operating temperature range (Operation above ambient T may lead to reduced capacity and lower voltage readings at the beginning of pulses)	-60/+85°C	-60/+55°C
--	-----------	-----------

Typical weight	29 g	29 g
----------------	------	------

### Key features

- Pack assembled from three ½ AA-sized (and UL-recognized) cells connected in series
- Component cells with stainless steel container and hermetic glass-to-metal sealing
- Plastic sleeve for battery housing
- Miniature snap-on terminals
- High and stable operating voltage
- Low self discharge rate (less than 1% after 1 year of storage at +20°C)
- Non-flammable electrolyte
- Non-restricted for transport

### Main applications

- Memory back-up
- Alarm and security devices
- Smoke detectors
- Alarm equipment
- Industrial electronics
- Medical equipment
- ... etc.



# LS 9 Volt battery pack

Voltage versus Current at +20°C (at mid-discharge)

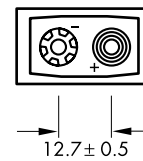
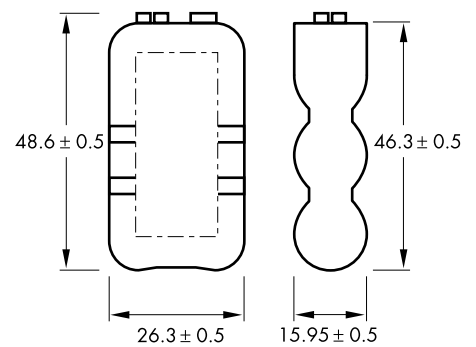
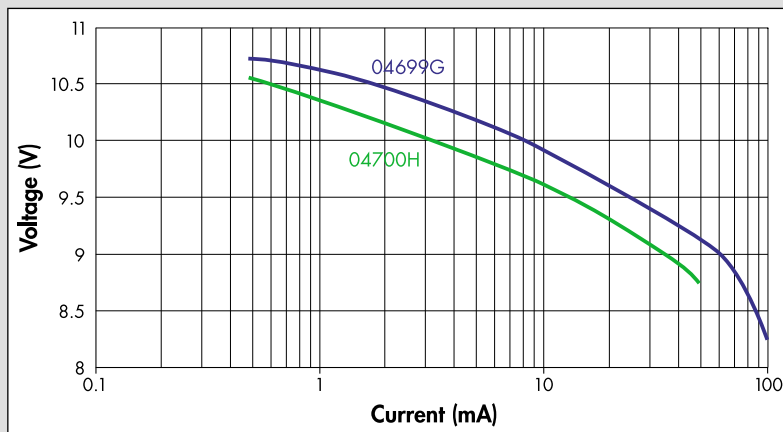

dimensions in mm

Restored Capacity versus Current at +20°C (6 V cut off)

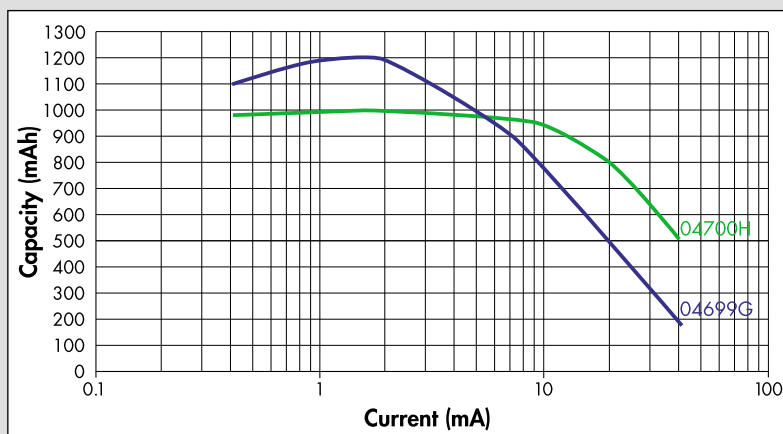

12, rue Sadi Carnot  
93170 Bagnolet - France  
Tel +33 1 49 93 17 25  
Fax +33 1 49 93 19 69  
[www.saftbatteries.com](http://www.saftbatteries.com)

Doc. N° 31022-2-1003  
Published by the Communications Department

Information in this document is subject to change without notice and becomes contractual only after written confirmation by Saft.